

RAZOR POWER DOOR OPERATING INSTRUCTIONS

- **Basic Operation:**

The Razor Power Door can be operated **up** and **down** from either of the Remote Key Pads mounted adjacent to the Roller Door the Electronic Controller mounted on the right side trailer chassis at the rear.

To operate, simply press the up (**blue**) button or down (**green**) button. Once activation has occurred the door will continue in that direction until it reaches the fully up or fully down position, and then turn itself off. The door can be stopped at any time by pressing the **stop** button

Please note: when the door stops in a direction, it cannot be activated in that direction again until it is activated in the opposite direction.

If the door stops part of the way open or closed, a brief press in the opposite direction will be necessary before the door can be operated in the desired direction.

Attention: Do not walk through the path of a moving door.

- **LED Operation on Main Keypad:** There are 3 LED's located on the main keypad. They are: **Orange-Service Light**, **Red-Operation Light** and **Green-Charge Light**. (See Pic)
- **Orange - Service Light-** This light may flash while the motor is driven and current is being drawn from the battery. If the orange light continues to flash after the motor has stopped or the motor will not run and the light flashes, the battery may be low on voltage. If the service light continues to flash, contact your authorized agent.
- **Red - Operation Light-** This light will flash once when the door motor is operated in either direction. The light will flash again when the motor stops.
- **Green - Charge Light-** The charge circuit will be connected to either your clearance lights or aux circuit (for further information contact your trailer builder/ installer). When the charge circuit is active it will flash to say the battery is charging and illuminate solid once the battery is full. If for some reason this light is not operating it may cause a flat battery. Contact your nearest agent for further information.

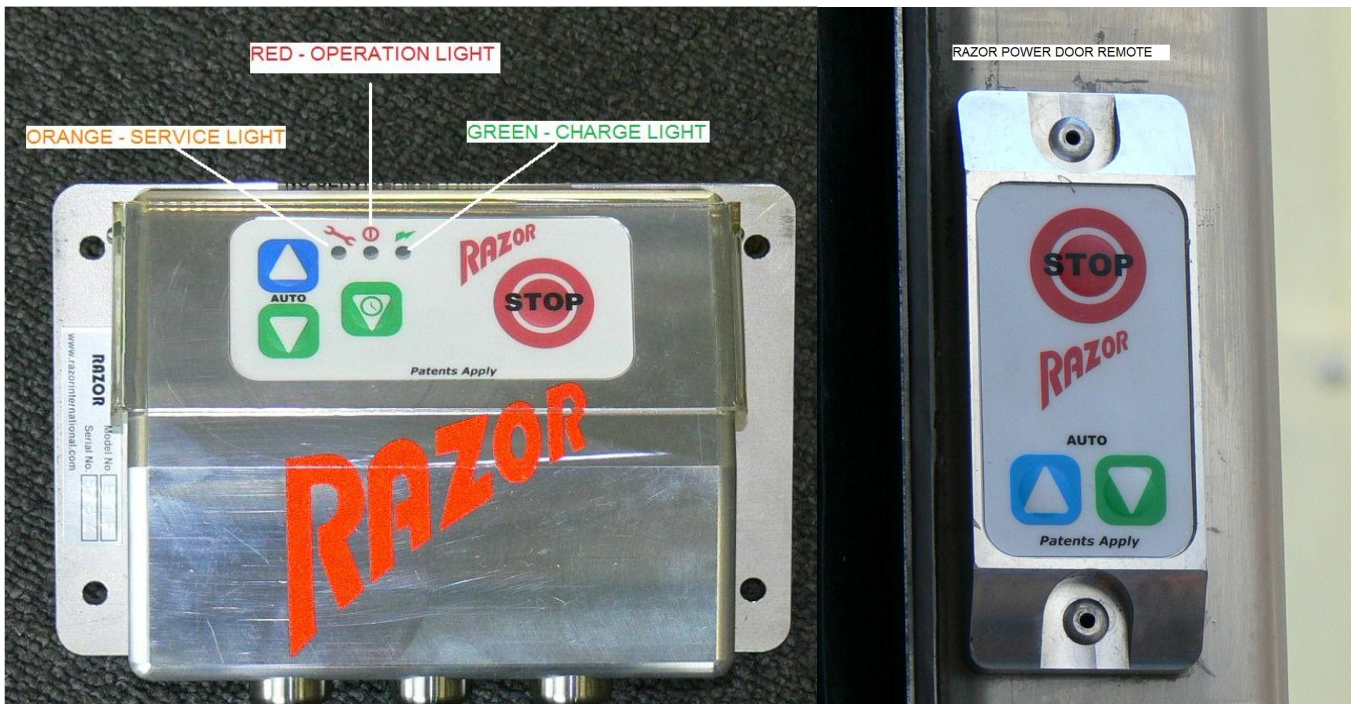

- **Manual Override-** The Razor Power Door can be manually operated in the case of emergencies. To operate simply use the door as if it was a non powered unit and contact your nearest agent for further information.
- **WARNING –** The manual override is only to be used as a last resort and Razor International take no responsibility for the door being operated in an unsafe manner. Contact your dealer immediately if the razor power door happens to stop working.
- **Maintenance:** Razor Power Door requires minimal maintenance.

Battery - To ensure trouble free operation. Check charge circuit daily to ensure the battery is being properly charged and the **GREEN CHARGE LIGHT** is flashing.

Door Operation- Razor Power Doors still require the spring tension on the wide slat roller doors to be maintained. Spring tensions should be set to manufacturer's specifications.

For any further information please contact your nearest authorized agent.

ENJOY SAFE & EASY TRUCKING WITH RAZOR POWER DOORS.